

CAN YOU SPOT THE 10 DIFFERENCES?

SPOT THE DIFFERENCES



TEACHER

GRADES 3-5

WHAT ITEMS GO WHERE AT SCHOOL?

DON'T THROW JUST ANYTHING OUT.

HELP CREATE A HEALTHY ENVIRONMENT: RECYCLE RIGHT AND TAKE OLD HABITS TO THE TRASH.



GET RID OF IT THE RIGHT WAY

PLAY THESE FUN GAMES TO LEARN WHAT GOES WHERE. IF YOU EVER FORGET WHAT BIN TO PUT THINGS IN, JUST LOOK AT THE PICTURES ON THE BINS OR ASK FOR HELP.

SOLVE THESE INCOMPLETE SENTENCES BY SELECTING THE RIGHT WORDS FROM THE WORD BANK.

DON'T BLANK OUT

LIQUIDS ~~NAPKINS~~
 RECYCLING ~~TRASH~~
 EMPTIED ~~SANDWICH BAGS~~
 STRAWS ~~CAPS~~

- MILK CARTONS MUST BE EMPTIED BEFORE THEY'RE RECYCLED.
- PUT PLASTIC CAPS ON EMPTY PLASTIC BOTTLES BEFORE RECYCLING THEM.
- REMOVE STRAWS FROM JUICE BOXES BEFORE RECYCLING THEM.
- POUR LEFTOVER MILK, SOUP AND WATER INTO THE LIQUIDS CONTAINER IN THE CAFETERIA.
- PAPER AND MAGAZINES GO IN THE RECYCLING BIN.
- PAPER NAPKINS GO IN THE TRASH BIN.
- THE TRASH BIN IS USED FOR ITEMS LIKE CHIP BAGS AND CANDY WRAPPERS.
- PLASTIC BOTTLES CAN BE RECYCLED, BUT PLASTIC SANDWICH BAGS BELONG IN THE TRASH.

CAFETERIA CLEANUP

COLOR AND SORT THESE COMMON CAFETERIA ITEMS.

DRAW LINES BETWEEN THE ITEMS AND THE BINS WHERE THEY BELONG.

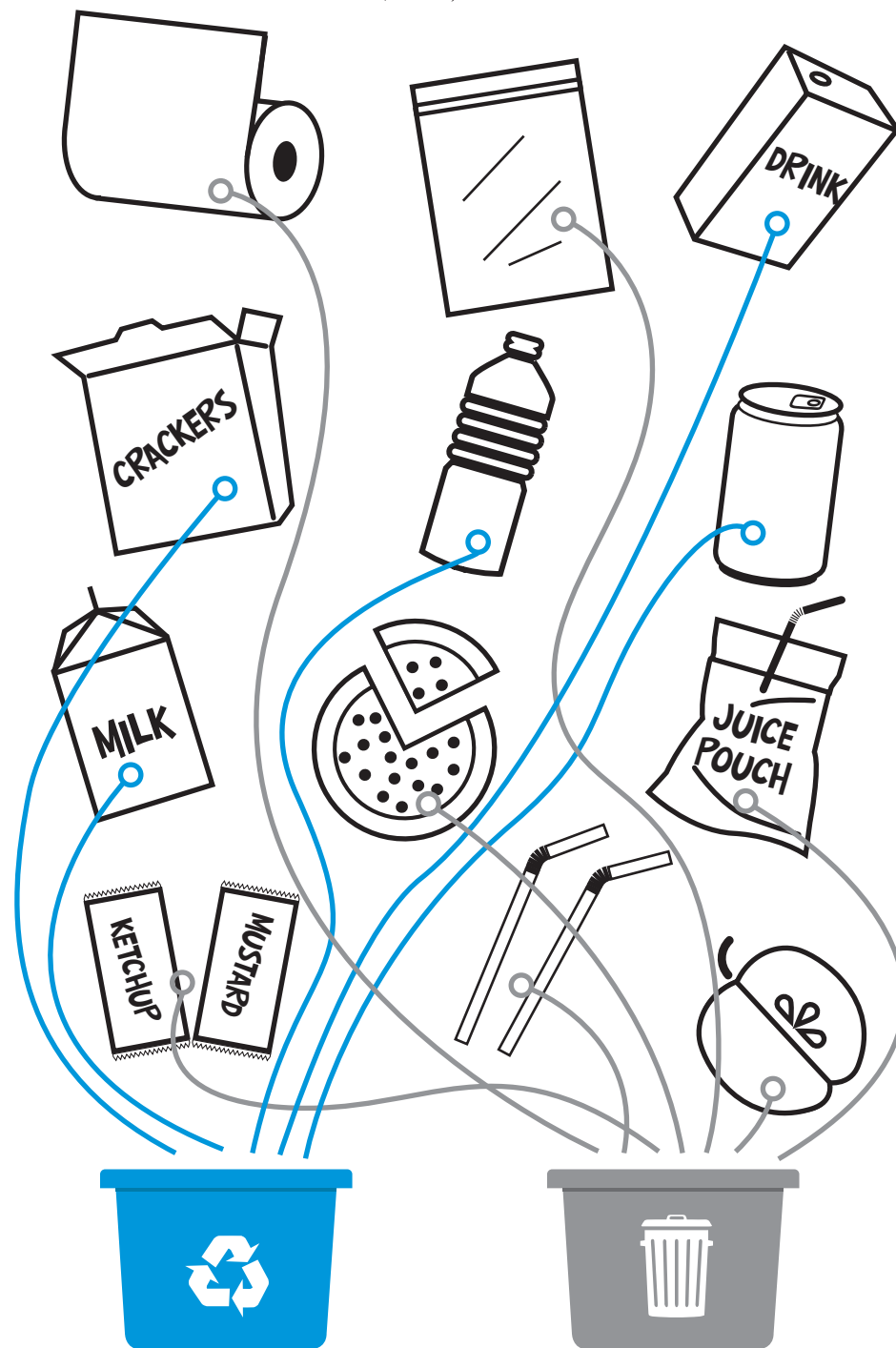

DON'T BE PUZZLED

SOLVE THIS CROSSWORD PUZZLE BY SELECTING THE RIGHT WORD FROM THE WORD BANK.

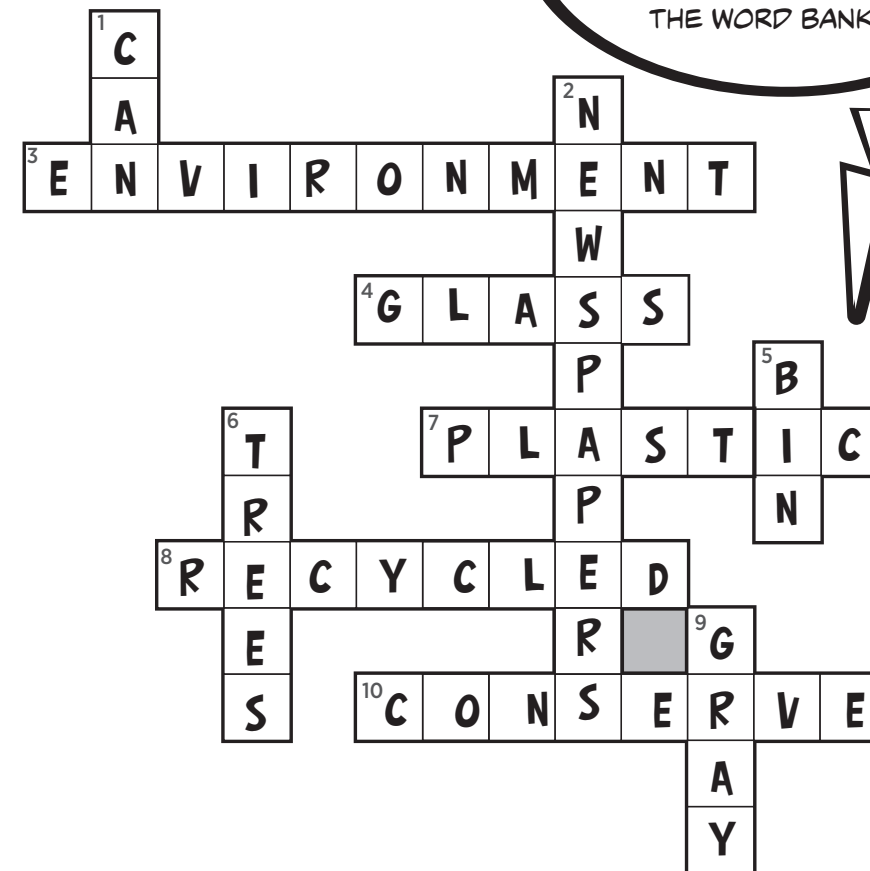

ENVIRONMENT ~~CAN~~ ~~CONSERVE~~ ~~GRAY~~
 RECYCLED ~~BIN~~ GLASS PLASTIC
 ~~TREES~~ NEWSPAPERS

ACROSS

- BY SORTING OUT RECYCLING FROM TRASH, YOU'RE CREATING A HEALTHY ENVIRONMENT.
- ALUMINUM AND GLASS NEVER WEARS OUT -- THEY CAN BE RECYCLED FOREVER.
- IN THE U.S., ONLY ONE OF EVERY FIVE PLASTIC BOTTLES IS RECYCLED.
- EMPTY MILK CARTONS AND JUICE BOXES SHOULD BE RECYCLED.
- RECYCLING HELPS TO CONSERVE NATURAL RESOURCES.

DOWN

- RECYCLING ONE ALUMINUM CAN SAVES ENOUGH ENERGY TO POWER A TV FOR THREE HOURS.
- RECYCLABLE PAPER ITEMS INCLUDE MAIL, CARDBOARD BOXES AND NEWSPAPERS.
- PLASTIC BAGGIES DON'T BELONG IN THE BLUE RECYCLING BIN.
- WHEN YOU RECYCLE PAPER, YOU SAVE TREES.
- CANDY WRAPPERS ARE TRASH, SO THEY GO IN THE BIN WITH THE GRAY LABEL.